

The High School Project



Community Meeting

September 27, 2021

Agenda

- Updates on:
 - Sustainability & Site Design
 - Landscaping Design
 - Site Access and Parking Allocations
- Budget & Schedule
- Questions and Answers

Minnie Howard Campus Site Usage and Sustainability

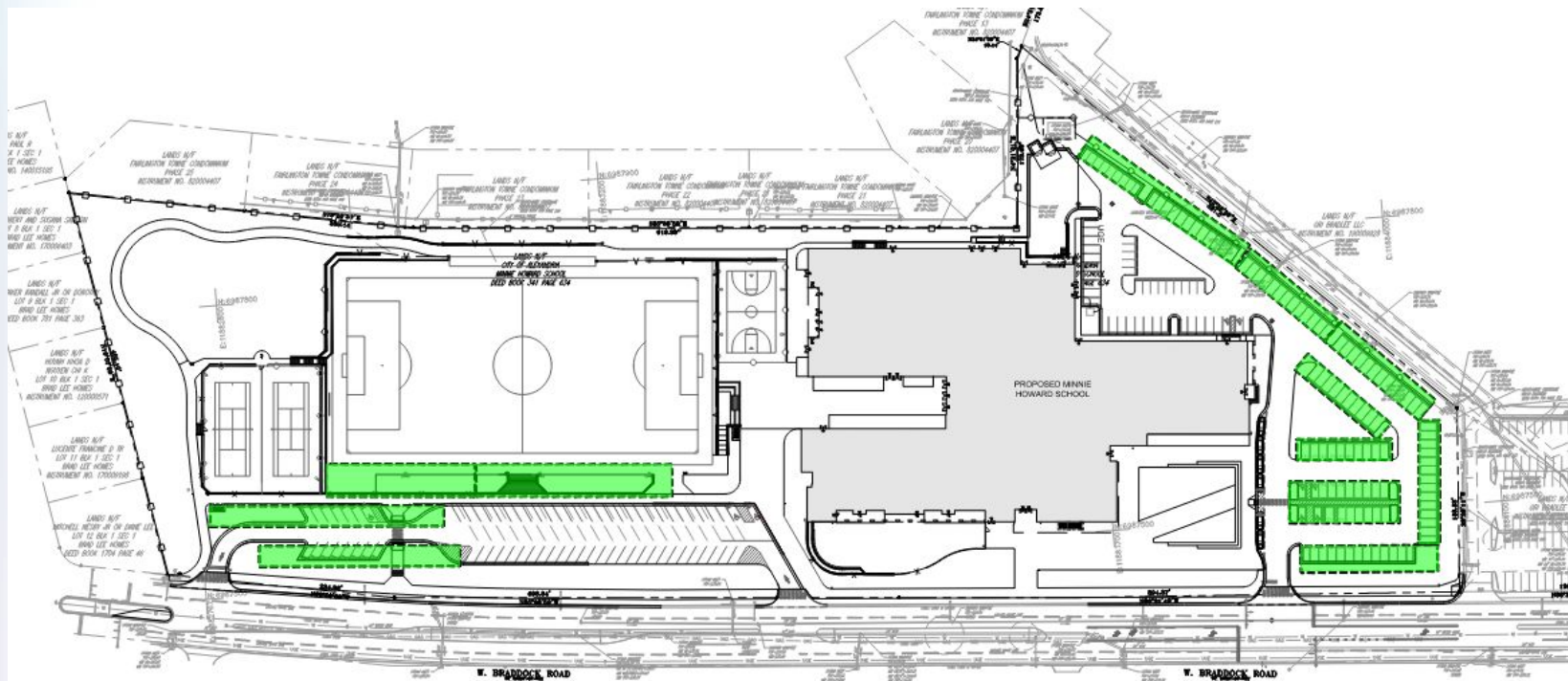

Structured Shading Elements with Photovoltaic Panels are highlighted in **green**. Photovoltaic Panels are also integrated into the Building Facades and on top of the roof.

Building Design & Sustainability

Project Sustainability Goals:

- High Performance School with a dynamic learning environment focusing on inclusion and sustainability
- Acquire LEED Gold Certification
- NZE (Net Zero Energy) Building
- Building to maximize natural daylighting of interiors
- Stormwater Management - Quality and Quantity



Site Sections

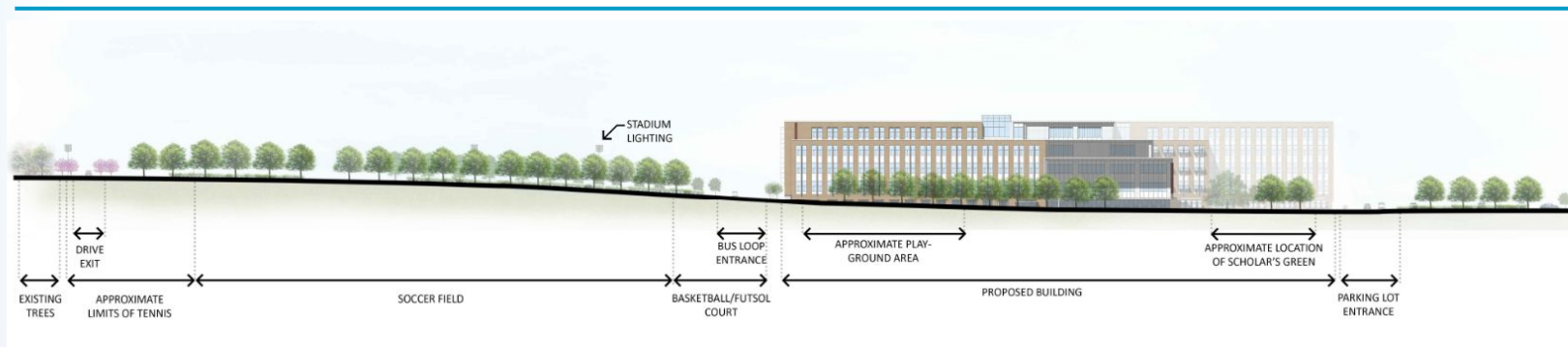

Tennis Court Light Height = 40 feet

Athletic Field Light Height = 60 feet

Ball net around majority of athletic field

Tiered retaining walls between Tennis, Athletic Field, and School

Perimeter landscape around athletic facilities

Landscape Design Plan



Design includes updates to landscaping and tree cover as sight buffer

Landscape Design



Autumn Blaze Red Maple



Willow Oak



American Hornbeam



American Sycamore



Thornless Honey Locust



Eastern Redbud



Nellie R. Stevens Holly



Eastern Red Cedar



Green Giant Arborvitae

Landscape Design



Red Chokeberry



Summersweet



Limelight Hydrangea



Northern Bayberry



Glossy Abelia



Lily Turf



Creeping Juniper



Wild Blue Phlox

Visual Screening Design Element



Board on Board Fence

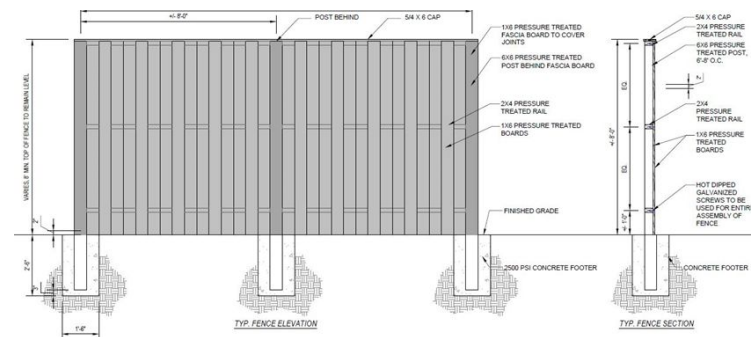

**Board on Board Fence:
Elevation and Section**

Field and Court Photometric

Field lighting calculations systems

Light cut off beyond field boundary

Site slopes, retaining walls

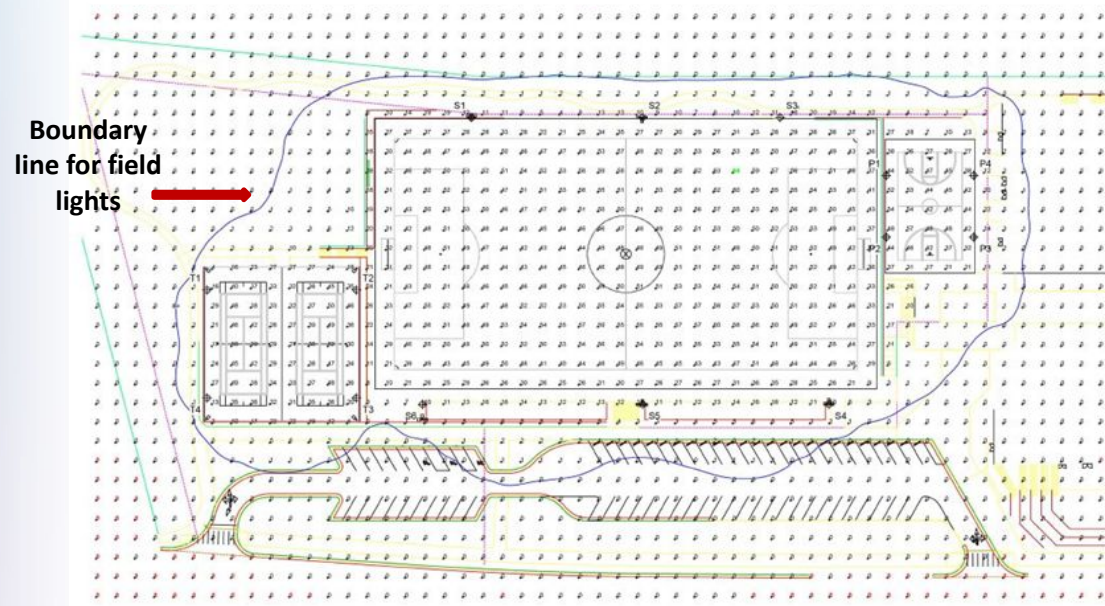

Soccer/Tennis Photometrics

Parking Lot Allocations

SITE PARKING SUMMARY	
Req'd Parking per Zoning Code	174 min. / 179 max.
Parking Provided	224 Total Spaces
	153 Eastern Parking Lot
	15 Western Parking Lot
	56 Shared Bus Loop

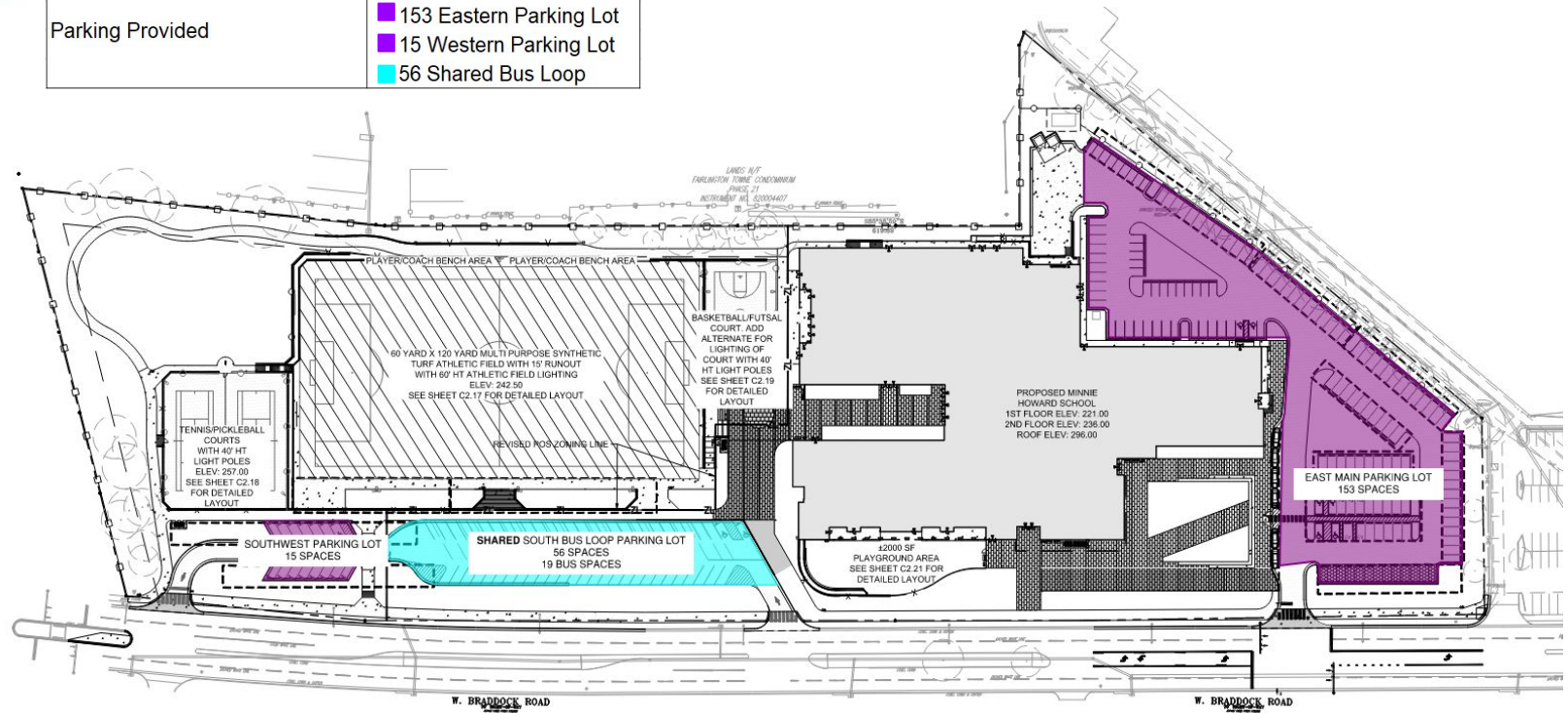

Polling Question - Landscape and Fence

How well do you think the proposed landscaping and fencing for Minnie Howard Campus meets the needs of the community?



- ☐ Very Well
- ☐ Well
- ☐ Neutral
- ☐ Not Well

Please add any specific comments in the Q&A feature.

Traffic and Pedestrian Access

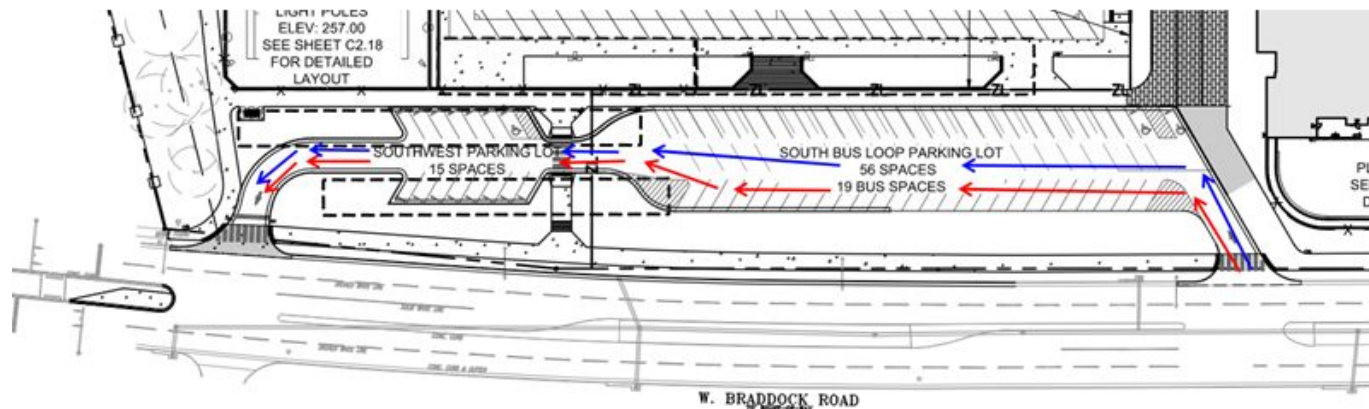
- Braddock Road circulation in and out (Median modification, added signal)
- Multiple access paths for cars, buses on site
- Distributed Parking East and West
- Pedestrian Access East, South, West from Public Way



 = CAR CIRCULATION
 = BUS CIRCULATION

Scale: NTS 

Eastern Parking Lot Traffic Flow

Proposed Traffic Flow Configuration

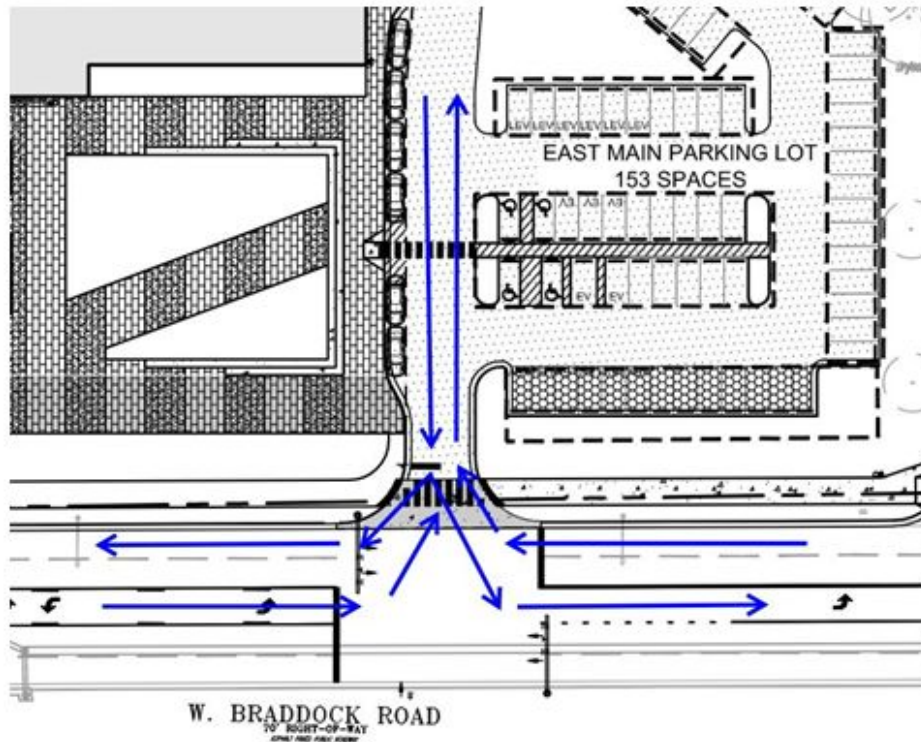

← = CAR CIRCULATION

Scale: NTS



Project Timeline

Educational Design Timeline

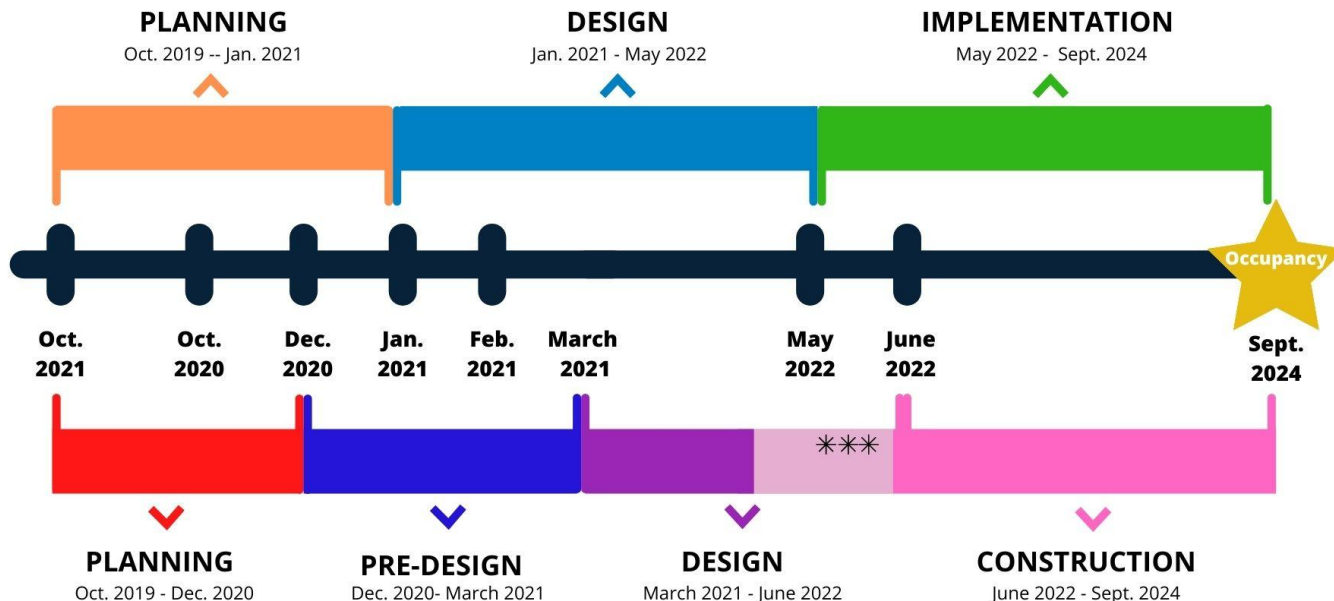

Construction Timeline

Based on the next steps described in previous slides, ACPs anticipates that this project will remain **on time**.

*** Indicates time potentially gained for construction from March 2022

Project Budget & Estimates

PROGRAMS	BUDGET	DD ESTIMATE
High School Program	\$150M	\$150.7M
Aquatic Facility	\$18.5M	\$18.1M
Alexandria Health Department (Teen Wellness Center)	TBD	\$1.1M
Department of Community and Human Services (DCHS) Spaces	TBD	\$7.8M

Given the size of this project, where we are in design, and the value management effort anticipated in the fall, ACPS expects to keep its portion of the project **on budget**.

Design Phase Meetings & Topics

***** Project Team anticipates frequent updates to the community prior to Planning Commission and City Council Hearings*****

Date	Topic
September 27, 2021	Design Updates on sustainability and site access.
*Nov/Dec 2021	Updates on building operational aspects including shared use of fields, pool and gym by school, RPCA and community; Updates on Budget and Project Costs
*Winter 2022	Updates from Planning Commission and City Council hearings; Next steps for the project
*Early Spring 2022	Final Meeting in preparation for construction

** Tentative date will need to be confirmed*

Questions & Feedback

Superintendent's Advisory Team Meeting

Wednesday, September 29, 2021 - 5:30 to 6:30 p.m.

<https://acpsk12.zoom.us/j/94660648329?pwd=RWgzTTBMYW14bCsyRy9yclVTTHNsQT09>

Contact us:

✉ Email: hsproject@acps.k12.va.us

Updates:

✉ Online: www.acps.k12.va.us/hsproject

✉ Newsletter: <https://k12.us3.list-manage.com/subscribe?u=c264d43033e4f4ca3b673bfc6&id=343e386a8d>



Thank You!



Superintendent
Dr. Gregory C. Hutchings, Jr.

School Board
Meagan L. Alderton, Chair
Veronica Nolan, Vice Chair

Cindy Anderson
Ramee A. Gentry
Jacinta Greene
Margaret Lorber

Michelle Rief
Christopher A. Suarez
Heather Thornton